

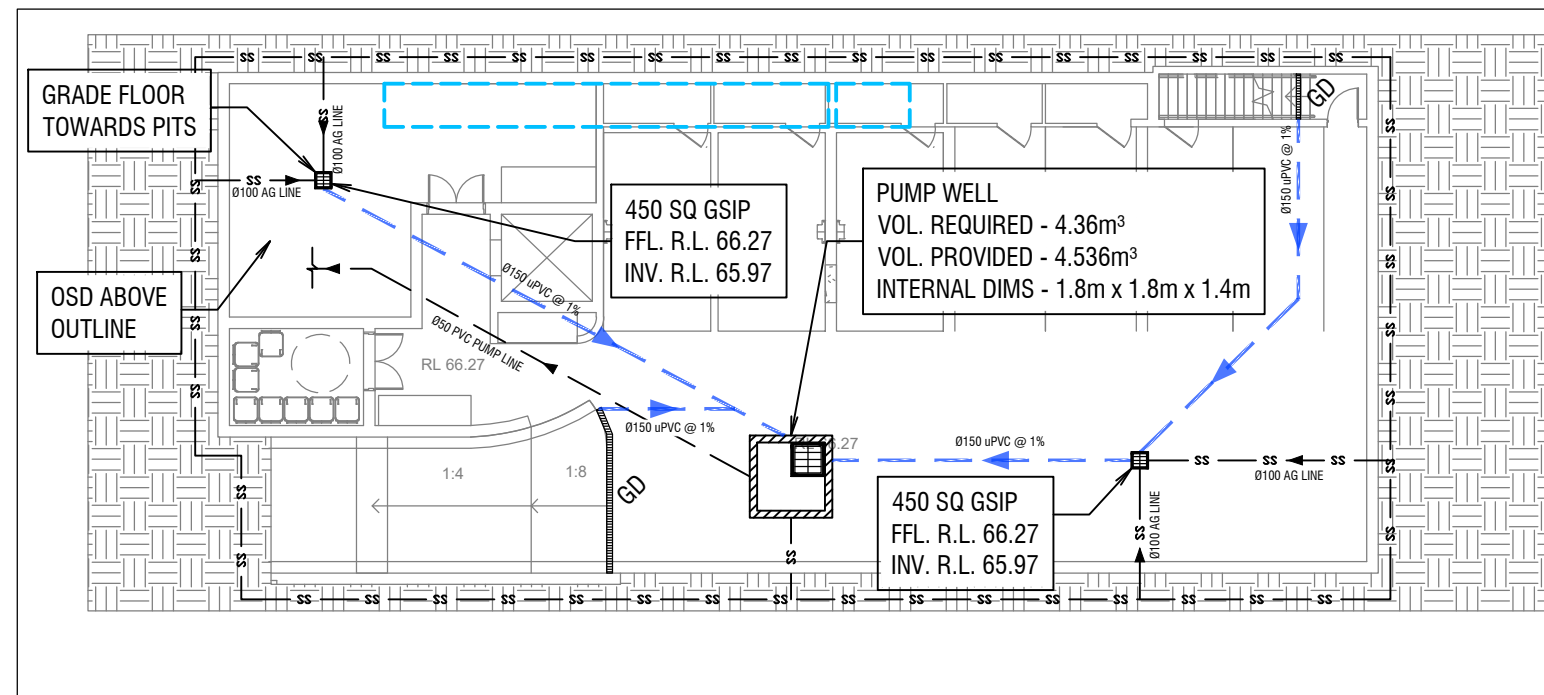

NOTE: PUMP CONTROL FLOAT LEVELS TO BE SET BY PLUMBER IN ACCORDANCE WITH AS 3500

| | | | |
|---|-----------------|----------|----------------|
| PUMP OUT PIT STORAGE CALCULATION | | | |
| AREA TO PUMP OUT PIT (RAMP + STAIRS) | = | 35 | m ² |
| 100 YEAR ARI FOR 2 HOUR STORM | = | 62.3 | mm/hr |
| TOTAL VOLUME FOR 2 HOUR STORM | 25 x 62.3 x 2 = | 4.36 | m ³ |
| | | | |
| 100 YEAR ARI FOR 5 MINUTE STORM | = | 271 | mm/hr |
| MINIMUM PUMP RATE REQUIRED | 25 x 271/3600 = | 2.634722 | L/s |









BASEMENT PUMP CALCULATION



BASEMENT STORMWATER PLAN

SCALE 1:200

LEGEND PROPOSED

- | | |
|--|--------------------------|
|  | STORMWATER PIPE |
|  | SUBSOIL DRAINAGE AG LINE |
|  | PVC PUMP LINE |
|  | GRATED PIT |
| DP. | DOWNPIPE |
| PD. | PLANTER DRAIN |
| FW. | FLOOR WASTE |
|   | GRATED DRAIN |
|  | OSD/RWT TANK ABOVE |
|  | BOUNDARY LINE |

NOTES:

1. ALL WORK IS TO BE CARRIED OUT IN ACCORDANCE WITH RANDWICK CITY COUNCIL'S DCP, AS3500.3 STORMWATER DRAINAGE.
2. THE CONTRACTOR IS TO LOCATE AND LEVEL ALL EXISTING SERVICES PRIOR TO THE COMMENCEMENT OF CONSTRUCTION, WHETHER INDICATED ON THE PLANS OR NOT, AND MAKE ARRANGEMENTS WITH THE RELEVANT AUTHORITY TO RELOCATE OR ADJUST IF NECESSARY. ANY DAMAGE TO EXISTING SERVICES SHALL BE RECTIFIED AT THE CONTRACTORS EXPENSE.
3. THE CONTRACTOR IS NOT TO ENTER UPON NOR DO ANY WORK WITHIN ADJOINING LANDS WITHOUT THE PERMISSION OF THE SUPERINTENDENT.
4. THE CONTRACTOR SHALL EFFECT TEMPORARY DRAINAGE MEASURES TO AVOID LOCALISED PONDING OF SURFACE RUN-OFF.
5. ALL NEW WORKS TO MAKE SMOOTH CONNECTION TO EXISTING CONDITIONS.
6. THE CONTRACTOR IS TO MAINTAIN SERVICES AND ALL WEATHER ACCESS AT ALL TIMES TO ADJOINING PROPERTIES.
7. ALL DRAINAGE ELEMENTS ARE SHOWN DIAGRAMMATICALLY BASED ON AVAILABLE DRAWINGS, TO BE INSTALLED WITH CONSIDERATION TO SITE CONSTRAINTS AND THE INTENT OF THE DRAINAGE CONCEPT.
8. ALL DOWNPIPES ARE SHOWN DIAGRAMMATICALLY, POSITIONS ARE TO BE CONFIRMED ON SITE USING THE WORKING DRAWINGS.
9. THE CONTRACTOR IS TO LOCATE AND LEVEL ALL EXISTING DRAINAGE PITS AND PIPES PRIOR TO THE COMMENCEMENT OF CONSTRUCTION AND THE CONSTRUCTION IS TO COMMENCE FROM THE DOWNSTREAM PIT AND STRUCTURES.
10. ALL DOWNPIPES ARE TO BE MINIMUM 90mm uPVC U.N.O.
11. STORMWATER PIPES DOWNSTREAM OF AN INLET PIT ARE TO BE MINIMUM 150mm uPVC ON 1% MINIMUM GRADE U.N.O. AND TO HAVE MIN 300mm COVER.
12. STORMWATER PIPES UPSTREAM OF AN INLET PIT ARE TO BE MINIMUM 90mm uPVC ON 1% MINIMUM GRADE U.N.O. AND TO HAVE MIN 300mm COVER.
13. ALL GUTTERS TO BE INSTALLED WITH GUTTER GUARDS UNLESS NOTED OTHERWISE.
14. ENSURE THAT ALL PITS AND PIPES ARE LOCATED CLEAR FROM ANY TREE ROOT SYSTEMS.
15. PROVIDE STEP IRONS WHERE PIT/TANK IS DEEPER THAN 1m.

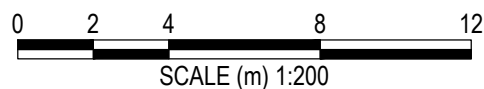

| REV | DATE | AMENDMENT / REVISION DESCRIPTION | TITLE | NAME |
|-----|------------|----------------------------------|--------------------|------|
| B | 01/07/2022 | ISSUED FOR COORDINATION | | |
| C | 13/07/2022 | ISSUED FOR \$4.55 | DRAWN _____ | JP |
| D | 30/06/2023 | ISSUED FOR COORDINATION | DESIGNED _____ | JP |
| E | 04/07/2023 | ISSUED FOR COORDINATION | DRG CHECK _____ | PH |
| F | 07/07/2023 | ISSUED FOR \$4.56 | | |
| G | 11/08/2023 | ISSUED FOR \$4.56 | DESIGN CHECK _____ | PH |
| H | 16/02/2024 | ISSUED FOR COORDINATION | APPROVED _____ | PH |
| J | 23/02/2024 | ISSUED FOR \$4.56 | | |

HYVE DESIGNS



ISSUED FOR \$4.56
NOT FOR CONSTRUCTION

SITE ADDRESS
33-35 CHURCH STREET, RANDWICK

CLIENT
S. KIANG

BASEMENT STORMWATER PLAN

THIS DRAWING AND THE INFORMATION CONTAINED THEREON HAVE BEEN CREATED SOLELY FOR A PARTICULAR PURPOSE AND CLIENT. THIS IS PROTECTED BY COPYRIGHT. YOU MAY NOT REPRODUCE ANY OF IT IN ANY FORM WITHOUT THE WRITTEN PERMISSION BY HYVE DESIGNS PTY LTD. IF YOU DO, YOU MAY HAVE TO PAY FOR DAMAGES TO HYVE DESIGNS PTY LTD OR YOU MAY BE PROSECUTED.

| | | | | |
|------------------------|--------------|--------------------|------------------|----------|
| JOB NUMBER: SC21087 | DATUM AHD | SCALE A3, 1:200 | SHEET No SW01 | REV J |
|------------------------|--------------|--------------------|------------------|----------|



LEGEND PROPOSED

- STORMWATER PIPE
- CHARGED LINE
- GRATED PIT
- DOWNPIPE
- PLANTER DRAIN
- FLOOR WASTE
- BOUNDARY LINE

SITE AREA: 588m²
EXISTING IMPERVIOUS AREA: 132m²
EXISTING ROOF AREA: 326m²
EXISTING PERVIOUS AREA: 130m²

5 YEAR ARI STORM OF 1 HOUR DURATION = 55.4 mm/hr

PSD = [(132 x 0.9) + (326 x 1) + (130 x 0.6054)] x 55.4 / 3600
PSD = 8.06 L/s

PSD CALCULATION

SERVICES SHOWN ARE INDICATIVE ONLY. CONTRACTOR SHALL CONFIRM ALL SERVICE LOCATIONS AND DEPTHS PRIOR TO EXCAVATION

ALL DRAINAGE LINES, BENDS, AND PITS ARE TO BE SEALED.

STORMWATER PIPES TO BE 100mm DIA. uPVC UNO.

NOTES:

- ALL WORK IS TO BE CARRIED OUT IN ACCORDANCE WITH RANDWICK CITY COUNCIL'S DCP, AS3500.3 STORMWATER DRAINAGE.
- THE CONTRACTOR IS TO LOCATE AND LEVEL ALL EXISTING SERVICES PRIOR TO THE COMMENCEMENT OF CONSTRUCTION, WHETHER INDICATED ON THE PLANS OR NOT, AND MAKE ARRANGEMENTS WITH THE RELEVANT AUTHORITY TO RELOCATE OR ADJUST IF NECESSARY. ANY DAMAGE TO EXISTING SERVICES SHALL BE RECTIFIED AT THE CONTRACTORS EXPENSE.
- THE CONTRACTOR IS NOT TO ENTER UPON NOR DO ANY WORK WITHIN ADJOINING LANDS WITHOUT THE PERMISSION OF THE SUPERINTENDENT.
- THE CONTRACTOR SHALL EFFECT TEMPORARY DRAINAGE MEASURES TO AVOID LOCALISED PONDING OF SURFACE RUN-OFF.
- ALL NEW WORKS TO MAKE SMOOTH CONNECTION TO EXISTING CONDITIONS.
- THE CONTRACTOR IS TO MAINTAIN SERVICES AND ALL WEATHER ACCESS AT ALL TIMES TO ADJOINING PROPERTIES.
- ALL DRAINAGE ELEMENTS ARE SHOWN DIAGRAMATICALLY BASED ON AVAILABLE DRAWINGS, TO BE INSTALLED WITH CONSIDERATION TO SITE CONSTRAINTS AND THE INTENT OF THE DRAINAGE CONCEPT.
- ALL DOWNPIPES ARE SHOWN DIAGRAMATICALLY, POSITIONS ARE TO BE CONFIRMED ON SITE USING THE WORKING DRAWINGS.
- THE CONTRACTOR IS TO LOCATE AND LEVEL ALL EXISTING DRAINAGE PITS AND PIPES PRIOR TO THE COMMENCEMENT OF CONSTRUCTION AND THE CONSTRUCTION IS TO COMMENCE FROM THE DOWNSTREAM PIT AND STRUCTURES.
- ALL DOWNPIPES ARE TO BE MINIMUM 90mm uPVC U.N.O.
- STORMWATER PIPES DOWNSTREAM OF AN INLET PIT ARE TO BE MINIMUM 150mm uPVC ON 1% MINIMUM GRADE U.N.O. AND TO HAVE MIN 300mm COVER.
- STORMWATER PIPES UPSTREAM OF AN INLET PIT ARE TO BE MINIMUM 90mm uPVC ON 1% MINIMUM GRADE U.N.O. AND TO HAVE MIN 300mm COVER.
- ALL GUTTERS TO BE INSTALLED WITH GUTTER GUARDS UNLESS NOTED OTHERWISE.
- ENSURE THAT ALL PITS AND PIPES ARE LOCATED CLEAR FROM ANY TREE ROOT SYSTEMS.
- PROVIDE STEP IRONS WHERE PIT/TANK IS DEEPER THAN 1m.

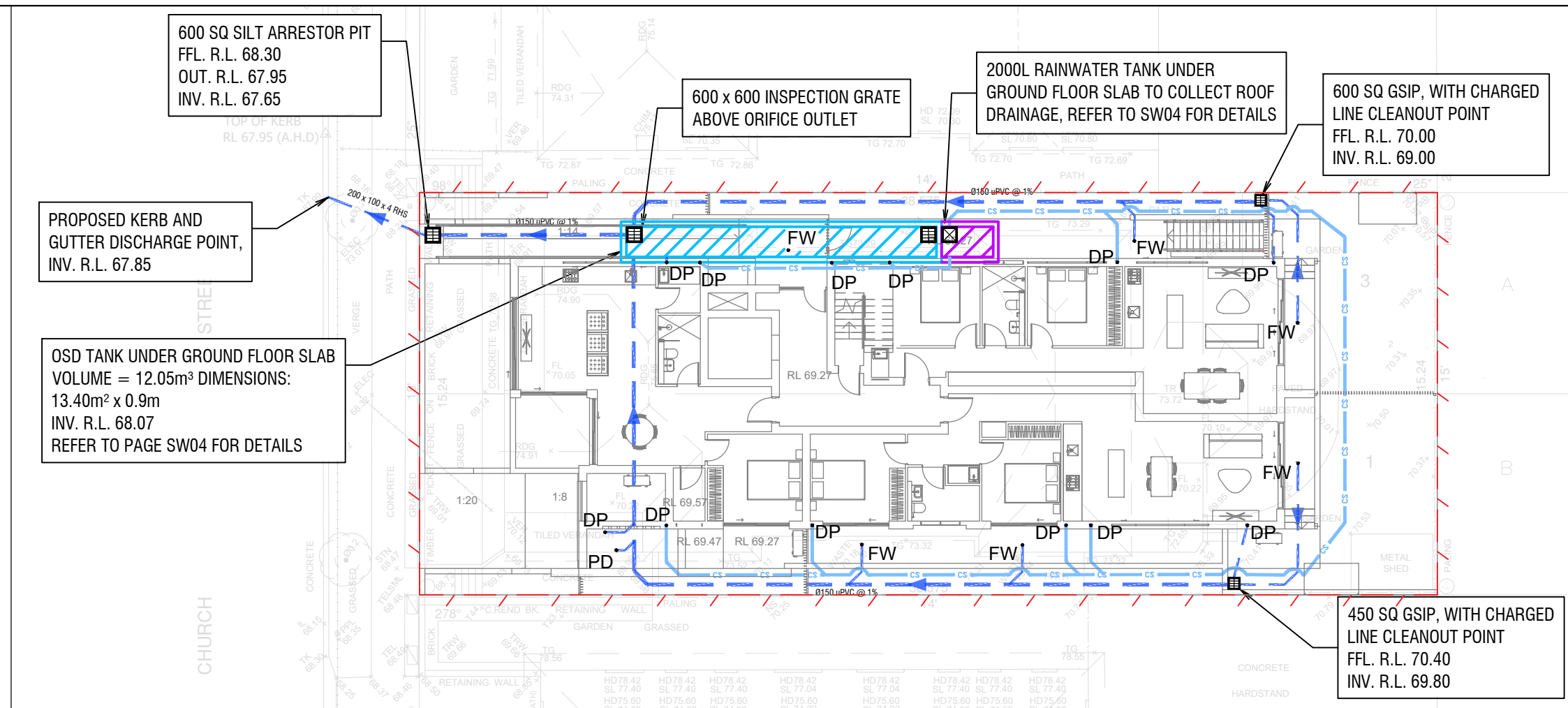
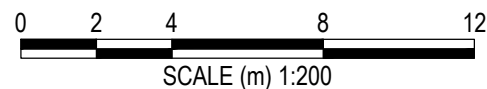

GROUND FLOOR STORMWATER PLAN

SCALE 1:200

| | RAINFALL INTESNITY | DISCHARGE | RUNOFF | PSD | OUTFLOW | STORAGE | |
|-------------|--------------------|-----------|----------------|------|----------------|----------------|--|
| hr | 1 in 20 | L/s | m ³ | L/s | m ³ | m ³ | |
| 0.08 | 213 | 29.64 | 8.54 | 8.06 | 2.32 | 6.22 | |
| 0.1 | 200 | 27.83 | 10.02 | 8.06 | 2.90 | 7.12 | |
| 0.17 | 167 | 23.24 | 14.22 | 8.06 | 4.93 | 9.29 | |
| 0.33 | 127 | 17.67 | 20.99 | 8.06 | 9.57 | 11.42 | |
| 0.5 | 106 | 14.75 | 26.55 | 8.06 | 14.50 | 12.05 | |
| 0.67 | 91.5 | 12.73 | 30.71 | 8.06 | 19.43 | 11.28 | |
| 0.83 | 81 | 11.27 | 33.68 | 8.06 | 24.07 | 9.61 | |
| 1 | 72.9 | 10.14 | 36.52 | 8.06 | 29.00 | 7.52 | |
| 1.17 | 66.6 | 9.27 | 39.03 | 8.06 | 33.93 | 5.10 | |
| 2 | 47.2 | 6.57 | 47.29 | 8.06 | 58.00 | -10.71 | |
| OSD STORAGE | | | | | | 12.05 | |

OSD MASS CURVE STORAGE CALCULATIONS

ORIFICE DESIGN

$$A_o = Q / (C_d \times \text{SQRT}(2gh))$$

| | | |
|------------------|---------|-------------------|
| Q | 0.00806 | m ³ /s |
| C _d | 0.6 | |
| g | 9.8 | m/s ² |
| h | 0.9 | m |
| A _o | 0.00320 | m ² |
| ORIFICE DIAMETER | 63.8 | mm |

ORIFICE PLATE CALCULATION

ISSUED FOR \$4.56
NOT FOR CONSTRUCTION

| REV | DATE | AMENDMENT / REVISION DESCRIPTION | TITLE | NAME |
|-----|------------|----------------------------------|--------------|------|
| B | 01/07/2022 | ISSUED FOR COORDINATION | DRAWN | JP |
| C | 13/07/2022 | ISSUED FOR \$4.55 | DESIGNED | JP |
| D | 30/06/2023 | ISSUED FOR COORDINATION | DRG CHECK | PH |
| E | 04/07/2023 | ISSUED FOR COORDINATION | DESIGN CHECK | PH |
| F | 07/07/2023 | ISSUED FOR \$4.56 | APPROVED | PH |
| G | 11/08/2023 | ISSUED FOR \$4.56 | | |
| H | 16/02/2024 | ISSUED FOR COORDINATION | | |
| J | 23/02/2024 | ISSUED FOR \$4.56 | | |





HYVE DESIGNS



| | | | | |
|---|--------------|--------------------|------------------|----------|
| SITE ADDRESS 33-35 CHURCH STREET, RANDWICK | | | | |
| CLIENT S. KIANG | | | | |
| GROUND FLOOR STORMWATER PLAN | | | | |
| THIS DRAWING AND THE INFORMATION CONTAINED THEREON HAVE BEEN CREATED SOLELY FOR A PARTICULAR PURPOSE AND CLIENT. THIS IS PROTECTED BY COPYRIGHT. YOU MAY NOT REPRODUCE ANY OF IT IN ANY FORM WITHOUT THE WRITTEN PERMISSION BY HYVE DESIGNS PTY LTD. IF YOU DO, YOU MAY HAVE TO PAY FOR DAMAGES TO HYVE DESIGNS PTY LTD OR YOU MAY BE PROSECUTED. | | | | |
| JOB NUMBER: SC21087 | DATUM AHD | SCALE A3, 1:200 | SHEET No SW02 | REV J |



LEGEND PROPOSED

-  STORMWATER PIPE
-  DOWNPIPE
-  PLANTER DRAIN
-  FLOOR WASTE
-  BOUNDARY LINE

PROPOSED AREAS

-  ROOF AREA
-  IMPERVIOUS AREA

SITE AREA: 588m²

EXISTING IMPERVIOUS AREA: 132m²

EXISTING ROOF AREA: 326m²

POST-DEVELOPMENT IMPERVIOUS AREA: 209m²

POST-DEVELOPMENT ROOF AREA: 222m²

NOTES:

- ALL WORK IS TO BE CARRIED OUT IN ACCORDANCE WITH RANDWICK CITY COUNCIL'S DCP, AS3500.3 STORMWATER DRAINAGE.
- THE CONTRACTOR IS TO LOCATE AND LEVEL ALL EXISTING SERVICES PRIOR TO THE COMMENCEMENT OF CONSTRUCTION, WHETHER INDICATED ON THE PLANS OR NOT, AND MAKE ARRANGEMENTS WITH THE RELEVANT AUTHORITY TO RELOCATE OR ADJUST IF NECESSARY. ANY DAMAGE TO EXISTING SERVICES SHALL BE RECTIFIED AT THE CONTRACTORS EXPENSE.
- THE CONTRACTOR IS NOT TO ENTER UPON NOR DO ANY WORK WITHIN ADJOINING LANDS WITHOUT THE PERMISSION OF THE SUPERINTENDENT.
- THE CONTRACTOR SHALL EFFECT TEMPORARY DRAINAGE MEASURES TO AVOID LOCALISED PONDING OF SURFACE RUN-OFF.
- ALL NEW WORKS TO MAKE SMOOTH CONNECTION TO EXISTING CONDITIONS.
- THE CONTRACTOR IS TO MAINTAIN SERVICES AND ALL WEATHER ACCESS AT ALL TIMES TO ADJOINING PROPERTIES.
- ALL DRAINAGE ELEMENTS ARE SHOWN DIAGRAMATICALLY BASED ON AVAILABLE DRAWINGS, TO BE INSTALLED WITH CONSIDERATION TO SITE CONSTRAINTS AND THE INTENT OF THE DRAINAGE CONCEPT.
- ALL DOWNPIPES ARE SHOWN DIAGRAMATICALLY, POSITIONS ARE TO BE CONFIRMED ON SITE USING THE WORKING DRAWINGS.
- THE CONTRACTOR IS TO LOCATE AND LEVEL ALL EXISTING DRAINAGE PITS AND PIPES PRIOR TO THE COMMENCEMENT OF CONSTRUCTION AND THE CONSTRUCTION IS TO COMMENCE FROM THE DOWNSTREAM PIT AND STRUCTURES.
- ALL DOWNPIPES ARE TO BE MINIMUM 90mm uPVC U.N.O.
- STORMWATER PIPES DOWNSTREAM OF AN INLET PIT ARE TO BE MINIMUM 150mm uPVC ON 1% MINIMUM GRADE U.N.O. AND TO HAVE MIN 300mm COVER.
- STORMWATER PIPES UPSTREAM OF AN INLET PIT ARE TO BE MINIMUM 90mm uPVC ON 1% MINIMUM GRADE U.N.O. AND TO HAVE MIN 300mm COVER.
- ALL GUTTERS TO BE INSTALLED WITH GUTTER GUARDS UNLESS NOTED OTHERWISE.
- ENSURE THAT ALL PITS AND PIPES ARE LOCATED CLEAR FROM ANY TREE ROOT SYSTEMS.
- PROVIDE STEP IRONS WHERE PIT/TANK IS DEEPER THAN 1m.

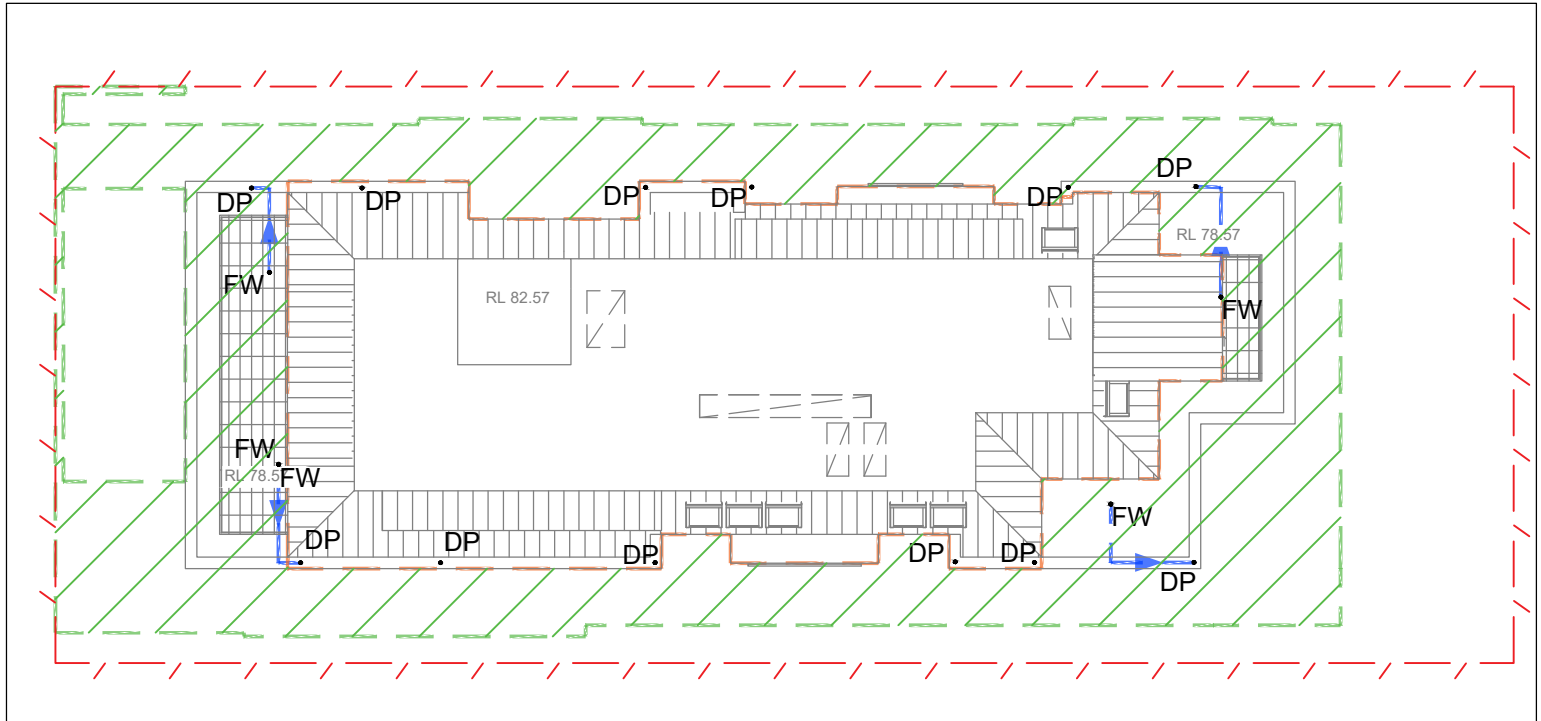
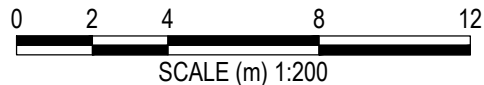

ROOF STORMWATER PLAN

SCALE 1:200

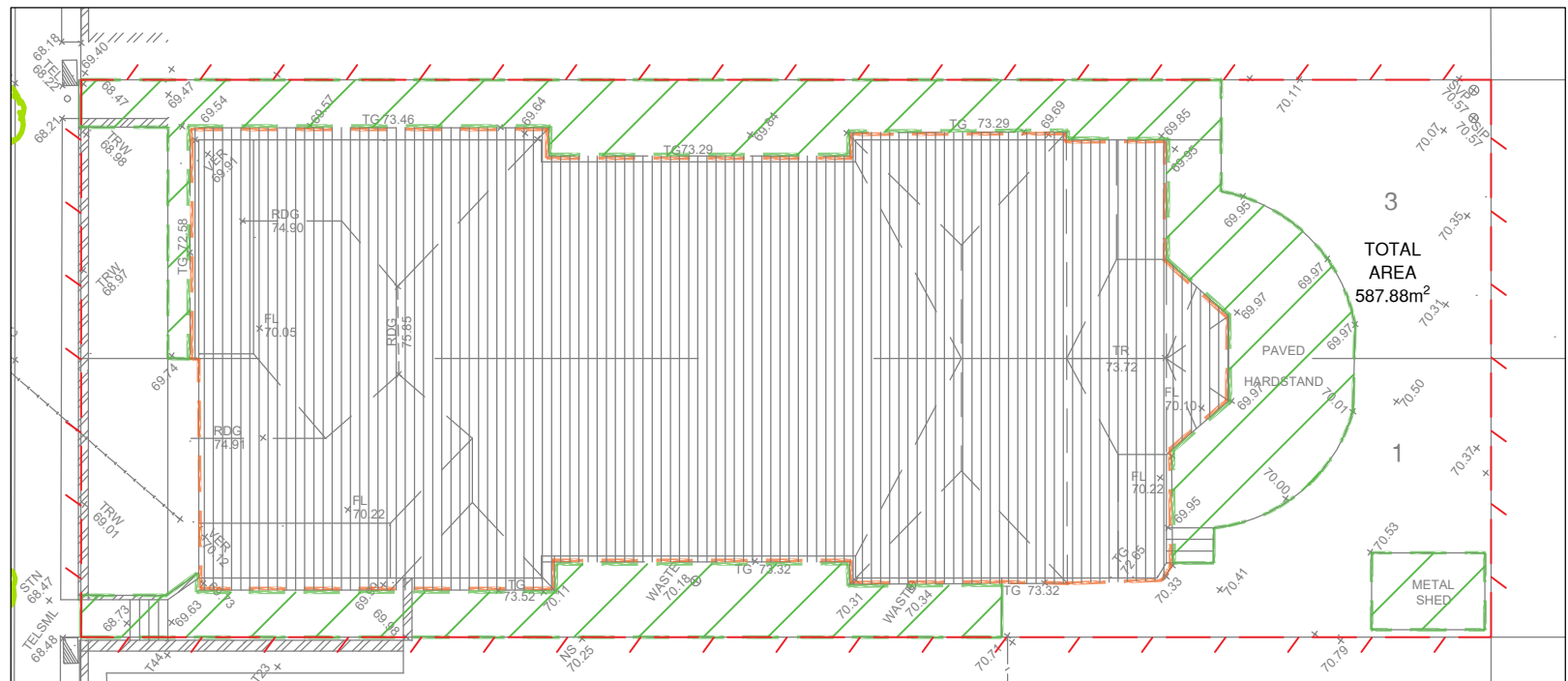

EXISTING AREAS

SCALE 1:200

ISSUED FOR \$4.56
NOT FOR CONSTRUCTION

| REV | DATE | AMENDMENT / REVISION DESCRIPTION | TITLE | NAME |
|-----|------------|----------------------------------|--------------|------|
| B | 01/07/2022 | ISSUED FOR COORDINATION | DRAWN | JP |
| C | 13/07/2022 | ISSUED FOR \$4.55 | DESIGNED | JP |
| D | 30/06/2023 | ISSUED FOR COORDINATION | DRG CHECK | PH |
| E | 04/07/2023 | ISSUED FOR COORDINATION | DESIGN CHECK | PH |
| F | 07/07/2023 | ISSUED FOR \$4.56 | APPROVED | PH |
| G | 11/08/2023 | ISSUED FOR \$4.56 | | |
| H | 16/02/2024 | ISSUED FOR COORDINATION | | |
| J | 23/02/2024 | ISSUED FOR \$4.56 | | |

HYVE DESIGNS



SITE ADDRESS
33-35 CHURCH STREET, RANDWICK

CLIENT
S. KIANG

STORMWATER CATCHMENT PLANS

THIS DRAWING AND THE INFORMATION CONTAINED THEREON HAVE BEEN CREATED SOLELY FOR A PARTICULAR PURPOSE AND CLIENT. THIS IS PROTECTED BY COPYRIGHT. YOU MAY NOT REPRODUCE ANY OF IT IN ANY FORM WITHOUT THE WRITTEN PERMISSION BY HYVE DESIGNS PTY LTD. IF YOU DO, YOU MAY HAVE TO PAY FOR DAMAGES TO HYVE DESIGNS PTY LTD OR YOU MAY BE PROSECUTED.

JOB NUMBER: SC21087
DATHUM: AHD
SCALE: A3, 1:200
SHEET No: SW03
REV: J



LEGEND PROPOSED

- STORMWATER PIPE
- DP DOWNPIPE
- PD PLANTER DRAIN
- FW FLOOR WASTE
- - - BOUNDARY LINE

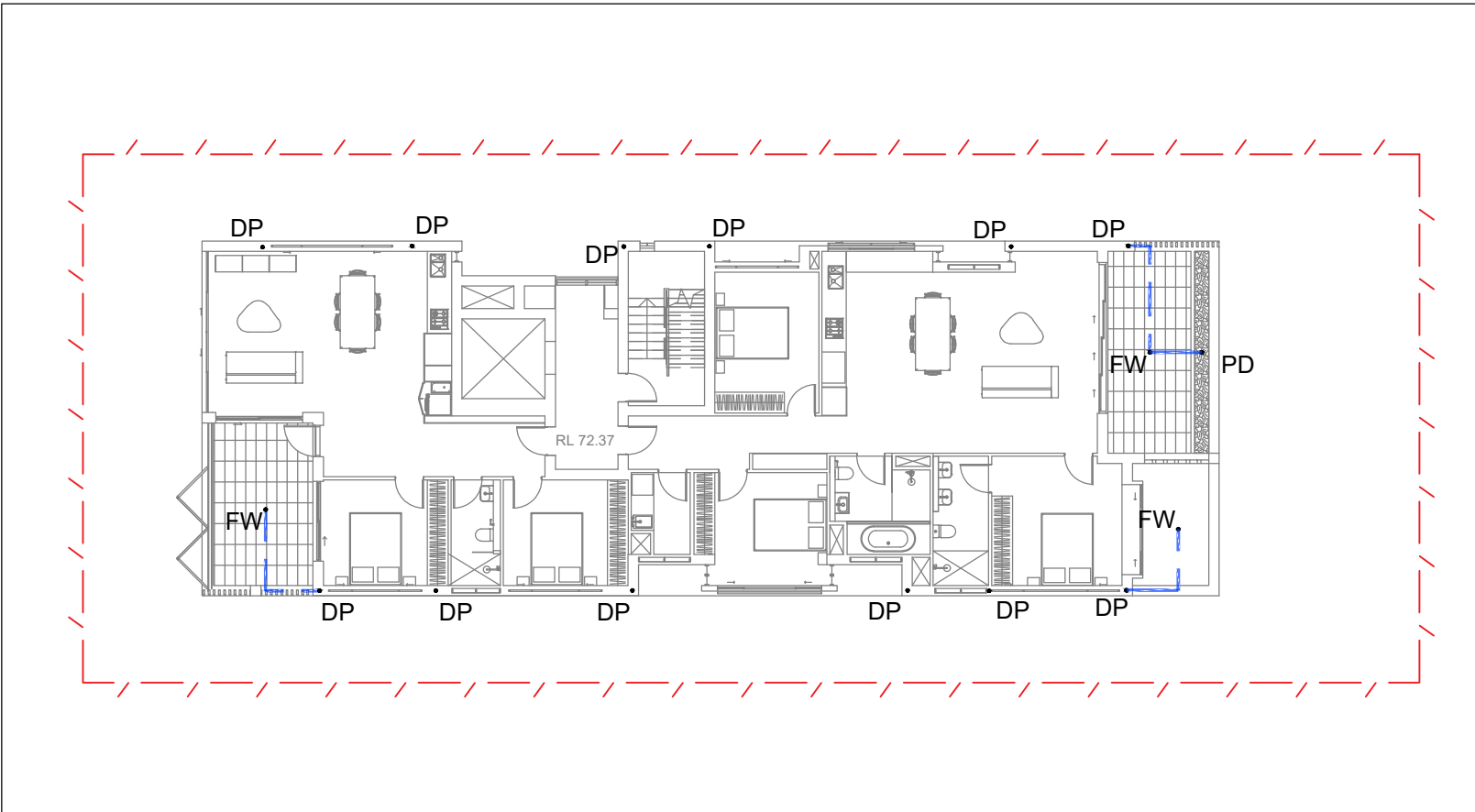

LEVEL 1 STORMWATER PLAN

SCALE 1:200

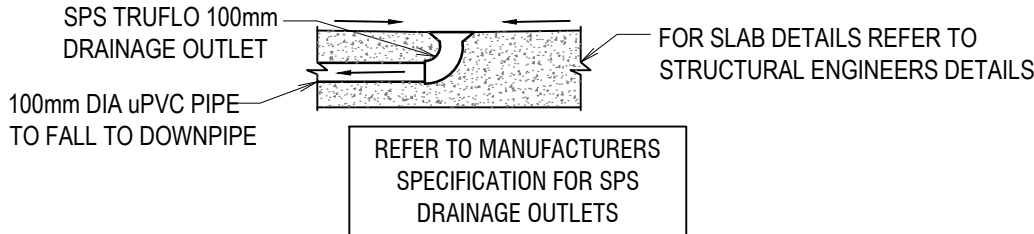

TYPICAL FLOOR WASTE

SCALE: NTS

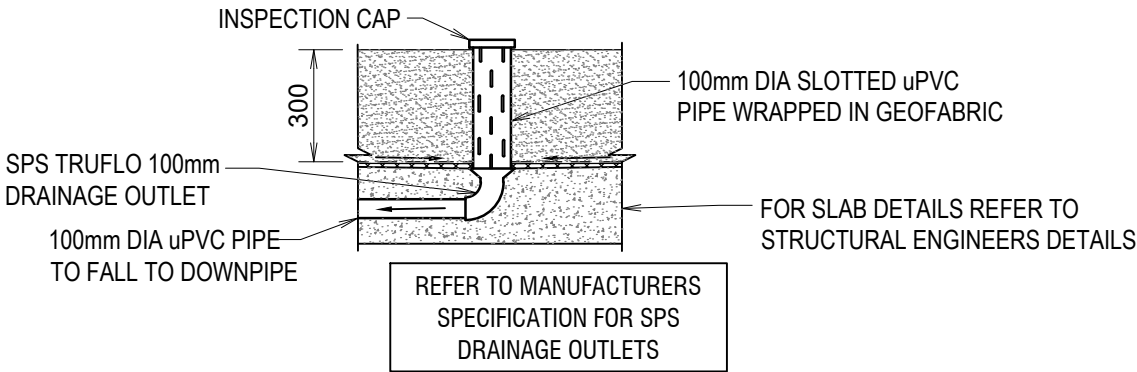

TYPICAL PLANTER DRAIN

SCALE: NTS

NOTES:

- ALL WORK IS TO BE CARRIED OUT IN ACCORDANCE WITH RANDWICK CITY COUNCIL'S DCP, AS3500.3 STORMWATER DRAINAGE.
- THE CONTRACTOR IS TO LOCATE AND LEVEL ALL EXISTING SERVICES PRIOR TO THE COMMENCEMENT OF CONSTRUCTION, WHETHER INDICATED ON THE PLANS OR NOT, AND MAKE ARRANGEMENTS WITH THE RELEVANT AUTHORITY TO RELOCATE OR ADJUST IF NECESSARY. ANY DAMAGE TO EXISTING SERVICES SHALL BE RECTIFIED AT THE CONTRACTORS EXPENSE.
- THE CONTRACTOR IS NOT TO ENTER UPON NOR DO ANY WORK WITHIN ADJOINING LANDS WITHOUT THE PERMISSION OF THE SUPERINTENDENT.
- THE CONTRACTOR SHALL EFFECT TEMPORARY DRAINAGE MEASURES TO AVOID LOCALISED PONDING OF SURFACE RUN-OFF.
- ALL NEW WORKS TO MAKE SMOOTH CONNECTION TO EXISTING CONDITIONS.
- THE CONTRACTOR IS TO MAINTAIN SERVICES AND ALL WEATHER ACCESS AT ALL TIMES TO ADJOINING PROPERTIES.
- ALL DRAINAGE ELEMENTS ARE SHOWN DIAGRAMATICALLY BASED ON AVAILABLE DRAWINGS, TO BE INSTALLED WITH CONSIDERATION TO SITE CONSTRAINTS AND THE INTENT OF THE DRAINAGE CONCEPT.
- ALL DOWNPIPES ARE SHOWN DIAGRAMATICALLY, POSITIONS ARE TO BE CONFIRMED ON SITE USING THE WORKING DRAWINGS.
- THE CONTRACTOR IS TO LOCATE AND LEVEL ALL EXISTING DRAINAGE PITS AND PIPES PRIOR TO THE COMMENCEMENT OF CONSTRUCTION AND THE CONSTRUCTION IS TO COMMENCE FROM THE DOWNSTREAM PIT AND STRUCTURES.
- ALL DOWNPIPES ARE TO BE MINIMUM 90mm uPVC U.N.O.
- STORMWATER PIPES DOWNSTREAM OF AN INLET PIT ARE TO BE MINIMUM 150mm uPVC ON 1% MINIMUM GRADE U.N.O. AND TO HAVE MIN 300mm COVER.
- STORMWATER PIPES UPSTREAM OF AN INLET PIT ARE TO BE MINIMUM 90mm uPVC ON 1% MINIMUM GRADE U.N.O. AND TO HAVE MIN 300mm COVER.
- ALL GUTTERS TO BE INSTALLED WITH GUTTER GUARDS UNLESS NOTED OTHERWISE.
- ENSURE THAT ALL PITS AND PIPES ARE LOCATED CLEAR FROM ANY TREE ROOT SYSTEMS.
- PROVIDE STEP IRONS WHERE PIT/TANK IS DEEPER THAN 1m.

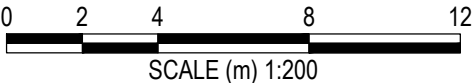

| REV | DATE | AMENDMENT / REVISION DESCRIPTION | TITLE | NAME |
|-----|------------|----------------------------------|--------------|------|
| B | 01/07/2022 | ISSUED FOR COORDINATION | DRAWN | JP |
| C | 13/07/2022 | ISSUED FOR S4.55 | DESIGNED | JP |
| D | 30/06/2023 | ISSUED FOR COORDINATION | DRG CHECK | PH |
| E | 04/07/2023 | ISSUED FOR COORDINATION | DESIGN CHECK | PH |
| F | 07/07/2023 | ISSUED FOR S4.56 | APPROVED | PH |
| G | 11/08/2023 | ISSUED FOR S4.56 | | |
| H | 16/02/2024 | ISSUED FOR COORDINATION | | |
| J | 23/02/2024 | ISSUED FOR S4.56 | | |

HYVE DESIGNS



ISSUED FOR S4.56
NOT FOR CONSTRUCTION

SITE ADDRESS
33-35 CHURCH STREET, RANDWICK

CLIENT
S. KIANG

LEVEL 1 STORMWATER PLAN

THIS DRAWING AND THE INFORMATION CONTAINED THEREON HAVE BEEN CREATED SOLELY FOR A PARTICULAR PURPOSE AND CLIENT. THIS IS PROTECTED BY COPYRIGHT. YOU MAY NOT REPRODUCE ANY OF IT IN ANY FORM WITHOUT THE WRITTEN PERMISSION BY HYVE DESIGNS PTY LTD. IF YOU DO, YOU MAY HAVE TO PAY FOR DAMAGES TO HYVE DESIGNS PTY LTD OR YOU MAY BE PROSECUTED.

| JOB NUMBER: | DATUM | SCALE | SHEET No | REV |
|-------------|-------|-----------|----------|-----|
| SC21087 | AHD | A3, 1:200 | SW04 | J |

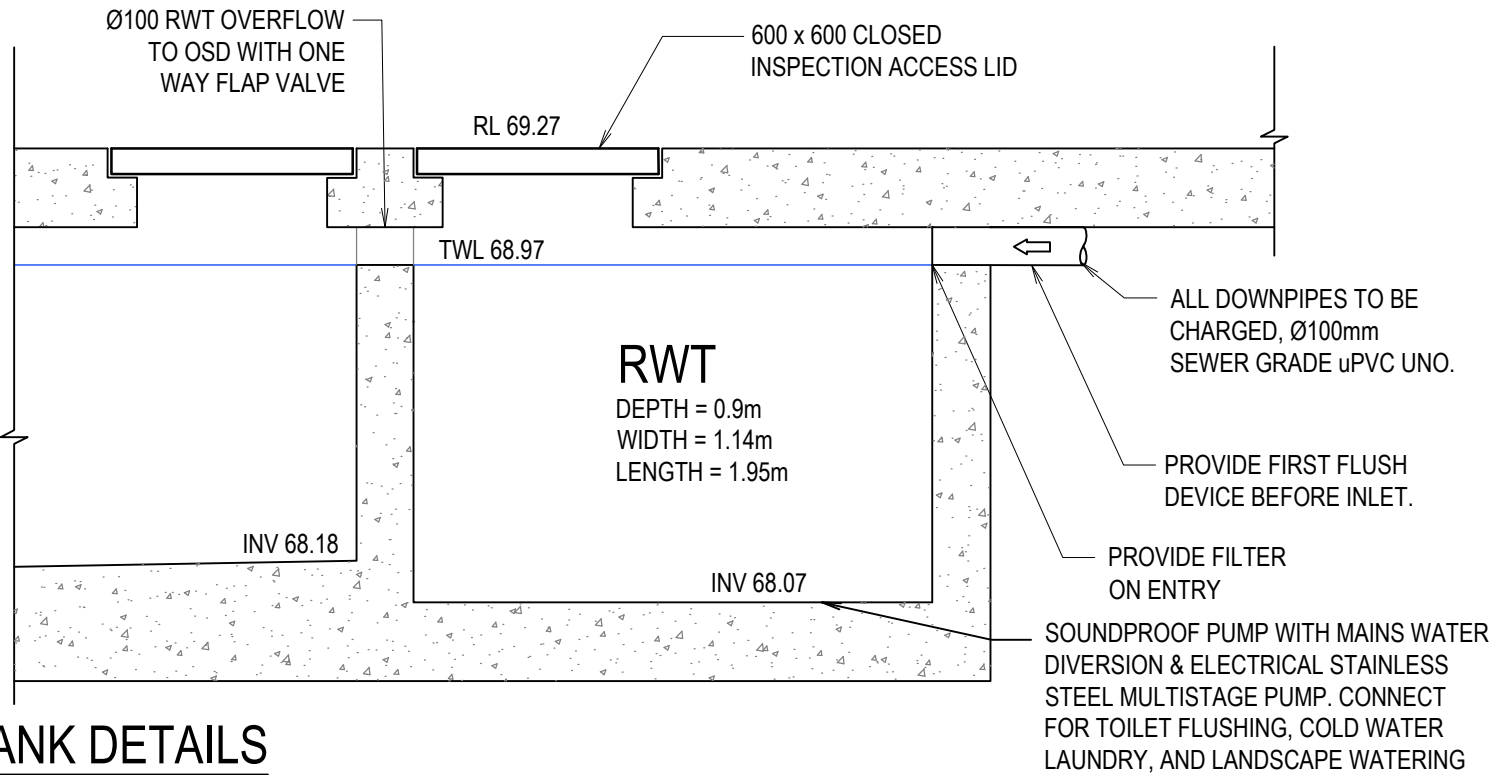
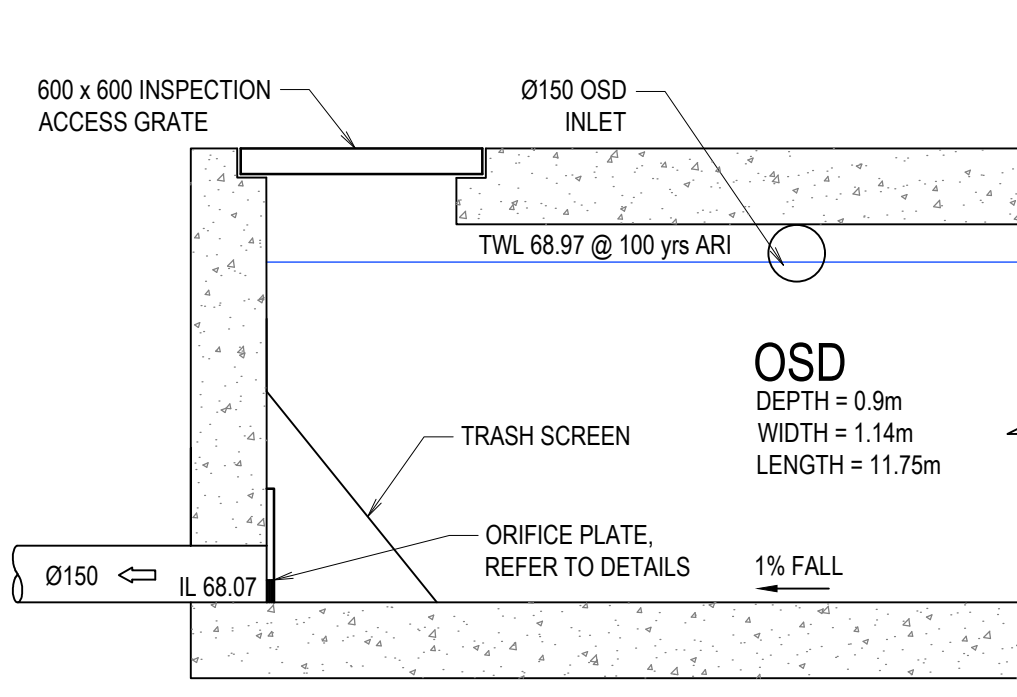

ON-SITE DETENTION + RAINWATER TANK DETAILS
SCALE: NTS

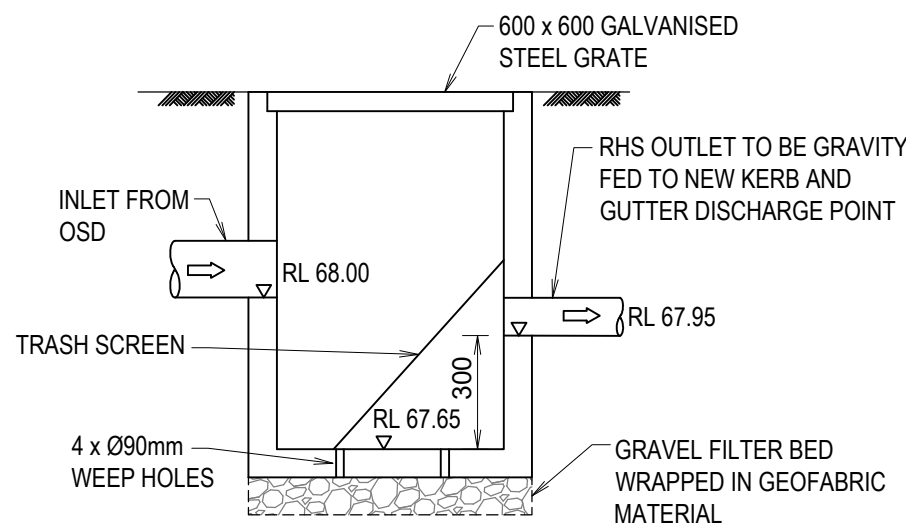

SILT ARRESTOR PIT DETAILS
SCALE: NTS

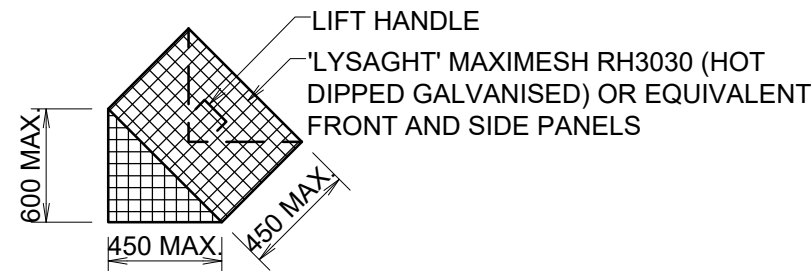

TRASH SCREEN DETAIL
N.T.S.

- TRASH SCREEN NOTES:**
- MAXIMESH SCREENS MUST BE PLACED SUCH THAT THE LONGAXIS OF THE OVAL SHAPED HOLES ARE ORIENTATED HORIZONTALLY WITH THE PORTRUDING LIP ANGLED UPWARDS AND FACING TOWARDS THE OUTLET.
 - THE SCREEN IS TO BE FORMED BY WELDING TWO TRIANGULAR MAXIMESH (OR EQUIVALENT) PANELS TO A RECTANGULAR FRONT MAXIMESH PANEL (OR EQUIVALENT).

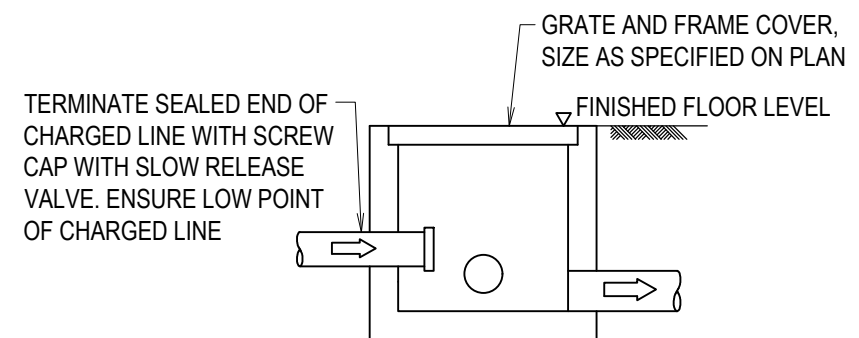

TYPICAL GRATED SURFACE INLET PIT
SCALE: N.T.S.

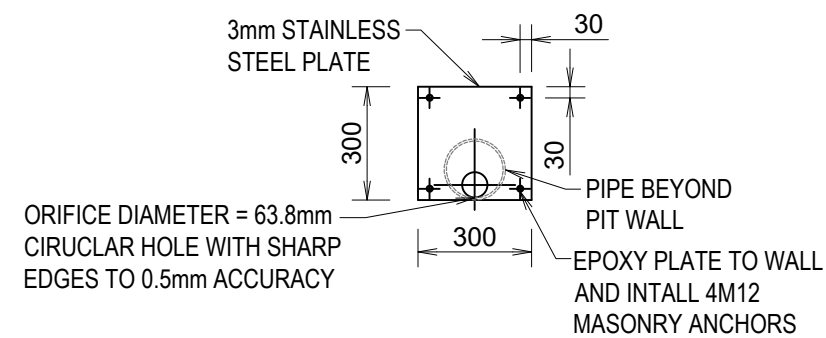

ORIFICE PLATE DETAIL
SCALE 1:20

- NOTES:**
- ALL WORK IS TO BE CARRIED OUT IN ACCORDANCE WITH RANDWICK CITY COUNCIL'S DCP, AS3500.3 STORMWATER DRAINAGE.
 - THE CONTRACTOR IS TO LOCATE AND LEVEL ALL EXISTING SERVICES PRIOR TO THE COMMENCEMENT OF CONSTRUCTION, WHETHER INDICATED ON THE PLANS OR NOT, AND MAKE ARRANGEMENTS WITH THE RELEVANT AUTHORITY TO RELOCATE OR ADJUST IF NECESSARY. ANY DAMAGE TO EXISTING SERVICES SHALL BE RECTIFIED AT THE CONTRACTORS EXPENSE.
 - THE CONTRACTOR IS NOT TO ENTER UPON NOR DO ANY WORK WITHIN ADJOINING LANDS WITHOUT THE PERMISSION OF THE SUPERINTENDENT.
 - THE CONTRACTOR SHALL EFFECT TEMPORARY DRAINAGE MEASURES TO AVOID LOCALISED PONDING OF SURFACE RUN-OFF.
 - ALL NEW WORKS TO MAKE SMOOTH CONNECTION TO EXISTING CONDITIONS.
 - THE CONTRACTOR IS TO MAINTAIN SERVICES AND ALL WEATHER ACCESS AT ALL TIMES TO ADJOINING PROPERTIES.
 - ALL DRAINAGE ELEMENTS ARE SHOWN DIAGRAMATICALLY BASED ON AVAILABLE DRAWINGS, TO BE INSTALLED WITH CONSIDERATION TO SITE CONSTRAINTS AND THE INTENT OF THE DRAINAGE CONCEPT.
 - ALL DOWNPIPES ARE SHOWN DIAGRAMATICALLY, POSITIONS ARE TO BE CONFIRMED ON SITE USING THE WORKING DRAWINGS.
 - THE CONTRACTOR IS TO LOCATE AND LEVEL ALL EXISTING DRAINAGE PITS AND PIPES PRIOR TO THE COMMENCEMENT OF CONSTRUCTION AND THE CONSTRUCTION IS TO COMMENCE FROM THE DOWNSTREAM PIT AND STRUCTURES.
 - ALL DOWNPIPES ARE TO BE MINIMUM 90mm uPVC U.N.O.
 - STORMWATER PIPES DOWNSTREAM OF AN INLET PIT ARE TO BE MINIMUM 150mm uPVC ON 1% MINIMUM GRADE U.N.O. AND TO HAVE MIN 300mm COVER.
 - STORMWATER PIPES UPSTREAM OF AN INLET PIT ARE TO BE MINIMUM 90mm uPVC ON 1% MINIMUM GRADE U.N.O. AND TO HAVE MIN 300mm COVER.
 - ALL GUTTERS TO BE INSTALLED WITH GUTTER GUARDS UNLESS NOTED OTHERWISE.
 - ENSURE THAT ALL PITS AND PIPES ARE LOCATED CLEAR FROM ANY TREE ROOT SYSTEMS.
 - PROVIDE STEP IRONS WHERE PIT/TANK IS DEEPER THAN 1m.

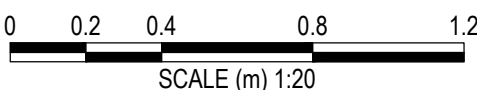

| REV | DATE | AMENDMENT / REVISION DESCRIPTION | TITLE | NAME |
|-----|------------|----------------------------------|--------------|------|
| B | 01/07/2022 | ISSUED FOR COORDINATION | DRAWN | JP |
| C | 13/07/2022 | ISSUED FOR S4.55 | DESIGNED | JP |
| D | 30/06/2023 | ISSUED FOR COORDINATION | DRG CHECK | PH |
| E | 04/07/2023 | ISSUED FOR COORDINATION | DESIGN CHECK | PH |
| F | 07/07/2023 | ISSUED FOR S4.56 | APPROVED | PH |
| G | 11/08/2023 | ISSUED FOR S4.56 | | |
| H | 16/02/2024 | ISSUED FOR COORDINATION | | |
| J | 23/02/2024 | ISSUED FOR S4.56 | | |

HYVE DESIGNS



**ISSUED FOR S4.56
NOT FOR CONSTRUCTION**

| | | | | |
|---|--------------|-------------------|------------------|----------|
| SITE ADDRESS 33-35 CHURCH STREET, RANDWICK | | | | |
| CLIENT S. KIANG | | | | |
| STORMWATER DETAILS | | | | |
| THIS DRAWING AND THE INFORMATION CONTAINED THEREON HAVE BEEN CREATED SOLELY FOR A PARTICULAR PURPOSE AND CLIENT. THIS IS PROTECTED BY COPYRIGHT. YOU MAY NOT REPRODUCE ANY OF IT IN ANY FORM WITHOUT THE WRITTEN PERMISSION BY HYVE DESIGNS PTY LTD. IF YOU DO, YOU MAY HAVE TO PAY FOR DAMAGES TO HYVE DESIGNS PTY LTD OR YOU MAY BE PROSECUTED. | | | | |
| JOB NUMBER: SC21087 | DATUM AHD | SCALE A3, 1:20 | SHEET No SW05 | REV J |